



THE LIFE AND WORK OF FRANK LLOYD WRIGHT

PART 3:
Ages 34 (1901) to 41 (1908)
In Chicago



JT Wunderlich PhD

website: <http://users.etoyn.edu/w/wunderjt/> [Architecture Portfolio](#)

8/28/2018



PART 1: Frank Lloyd Wright Age 0-19 (1867-1886) [PDF](#) [PPTX-w/audio](#) [MP4](#) [YouTube](#)

Context: Post Civil War recession. Industrial Revolution. Farm life. Preacher/Musician-Father, Teacher-Mother. Mother's large influential Unitarian family of Welsh farmers. Nature. Parent's divorce.

Architecture: Froebel schooling (e.g., blocks). Barns/farm-houses ([PDF](#) [PPTX-w/audio](#) [MP4](#) [YouTube](#)). Organic Architecture roots.

PART 2: Frank Lloyd Wright Age 20-33 (1887-1900) [PDF](#) [PPTX-w/audio](#) [MP4](#) [YouTube](#).

Context: Rebuilding Chicago after the Great Fire. Wife Catherine and first five children.

Architecture: Architects Joseph Silsbee and Louis Sullivan. Oak Park. Home & Studio. "Organic Architecture" begins.

PART 3: Frank Lloyd Wright Age 34-41 (1901-1908) [PDF](#) [PPTX-w/audio](#) [MP4](#) [YouTube](#). **THIS LECTURE**

Context: First Japan trip ([PDF](#) [PPTX-w/audio](#) [MP4](#) [YouTube](#)). Arts & Crafts movements. Six children.

Architecture: Prairie Style. Oak Park & River Forest, Unity Temple, Robie House, Larkin Building.

PART 4: Frank Lloyd Wright Age 42-47 (1909-1914) [PDF](#) [PPTX-w/audio](#) [MP4](#) [YouTube](#)

Context: Secession movement. Lived in Italy ([Page](#) [MP4](#) [YouTube](#)). Built Taliesin on family farmland. Mistress murdered.

Architecture: Wasmuth Portfolio published(Germany). Taliesin. Many operable windows for health & passive cooling. Sculptures.

PART 5: Frank Lloyd Wright Age 48-62 (1915-1929) [PDF](#) [PPTX-w/audio](#) [MP4](#) [YouTube](#)

Context: WWI, Roaring 20's. Short 2nd marriage. Lives 3 yrs in Japan, then California and Wisconsin. 3rd marriage (Olga).

Architecture: Tokyo Imperial Hotel. Textile Houses in California (with Mayan influences).

PART 6: Frank Lloyd Wright Age 63-78 (1930-1945) [PDF](#) [PPTX-w/audio](#) [MP4](#) [YouTube](#)

Context: 1930's Great Depression. WWII. Taliesin Fellowship/school. Utopian-Ideals(communal-living) Winters in AZ.

Architecture: Broadacre City, Fallingwater, Johnson Wax Building, Taliesin-West, Hanna-Honecomb House, Usonian Homes.

PART 7: Frank Lloyd Wright Age 79-91 (1946-1958++) [PDF](#) [MP4](#) [PPTX-w/audio](#) [YouTube](#)

Context: Post-WWII boom. Cold War. Communal living at Taliesin. FLW dies in 1959. Fellowship/school continued at Taliesin & Taliesin-West by Olga for 27 years -- and still exists today with some very recent changes (2020)

Architecture: Price Tower, Churches/Synagogue/Auditoriums. The Guggenheim. AZ homes, Modern materials.



Allan, Edward and Iana, Joseph. *Fundamentals of Building Construction: Materials and Methods*. Wiley; 7th edition (October 15, 2019).

American Institute of Architects. *AIA Guide to Chicago*. 2014.

Burns, Ken, and Novick, Lynn. *Frank Lloyd Wright: A Film by Ken Burns and Lynn Novick DVD*. PBS Home Video, August 28, 2001.

Bacon, Edmond. *Design of Cities*. Thames & Hudson Ltd, 1978.

Ching, Francis D.K. *Architecture: Form, Space, and Order*. 4 ed., Wiley, 2014.

Curtis, Stanley James. Friedrich Froebel; German educator. *Encyclopedia Britannica*, 2018. <https://www.britannica.com/biography/Friedrich-Froebel>

Fazio, M., Moffett, M., and Wodehouse, L. *Buildings Across Time: An introduction to world architecture*. 4th edition, McGraw-Hill, 2012.

Fici, Filipo. Frank Lloyd Wright in Florence and Fiosole. *Frank Lloyd Wright Quarterly*, Vol. 22 no.4, 2011.

Find a grave; William Carey Wright, 2018. <https://www.findagrave.com/memorial/55462361/william-carey-wright>

Frank Lloyd Wright Trust. *1905: Japan through the Lens of Frank Lloyd Wright*, 2017. <https://www.wrightsjapan1905.org/>

Frank Lloyd Wright Trust. *Unity Temple*, 2018. <https://flwright.org/researchexplore/unitytemple>

Froebel; Brief History of the Kindergarten. Froebel Gifts, 2013. <http://www.froebelgifts.com/history.htm>

Ho-o-Den, An Illustrated Description of the Buildings Erected by the Japanese Government at the World's Columbian Exposition. K. Ogawa publisher, Tokyo, 2018.

Hoffman, Anna. *Gustav Stickley: the American Arts & Crafts Movement*. Sept 16, 2010.

Huxtable, Ada Louise. *Frank Lloyd Wright*. New York Times, Oct. 31, 2004. <https://www.nytimes.com/2004/10/31/books/chapters/frank-lloyd-wright.html>

Kaufman, Clare. *The History of Higher Education in the United States*. WoroldWideLearn. 2018. <https://www.worldwidelearn.com/education-advisor/indepth/history-higher-education.php>

Kitagawa, Joseph Mitsuo. *On Understanding Japanese Religion*. Princeton University Press, 1987.

Lechner, Norbert. *Heating, cooling, lighting*. Wiley, 4th edition, October 13, 2014.

LEED (Leadership in Energy and Environmental Design), The United States Green Building Council, 2018. <https://new.usgbc.org/leed>

Life of Olgivanna Lloyd Wright Reviewed by Architects and Artisans. *ORO Editions*. Sep 12, 2017. <https://www.oroeditions.com/2017/09/12/the-life-of-olgivanna-lloyd-wright-reviewed-by-architects-and-artisans/>

Lynch, Kevin. *The Image of The City*. MIT Press, 1960.

PENN Rare Book and Manuscript: Frank Lloyd Wright's Paternal Family. Penn Library. University of Pennsylvania, Feb. 20, 2014. <http://www.library.upenn.edu/rbm/featured/mscoll822.html>

Pearson, David. *The Breaking Wave: New Organic Architecture*. Stroud: Gaia, 2001.

Siry, Joseph M. *The Architecture of Earthquake Resistance*. *Journal of the Society of Architectural Historians*, Vol 67 (1): pp78–105, 2008.

Storrer, William Allin. *The Architecture of Frank Lloyd Wright, a Complete Catalog, 4th edition*. Chicago, University of Chicago Press, 2017.

Stevens, John L. *Incidence of travel in Yucatán*. Sastrugi Press, 2019.

Stevens, John L. *Incidence of travel in Central America, Chiapas, and Yucatán*. Dover Publications, 1969.

Unity Chapel, Unity Chapel Inc. 2018. <http://www.unitychapel.org/familyhistory/>

Vargas, A.P. and Schierle, G.G., The textile block system: seismic analysis and upgrading, *WIT Transactions on State of the Art in Science and Engineering*, Vol 62 WIT Press 2013.

Kim, Daeshick, and Back, Alan. *The Way to go: philosophy in martial arts practice*. Nanam Publishing House, 2000.

Wright, Frank Lloyd. *The Art and Craft of the Machine*, Vol. 8, No. 2 pp. 77-81, 83-85, 87-90, May, 1901. [tps://www.jstor.org/stable/pdf/25505640.pdf](https://www.jstor.org/stable/pdf/25505640.pdf)

Wright, Frank Lloyd. In the Cause of Architecture. *Architectural Record*, vol. XXIII, March 1908.

Wright, Frank Lloyd. *(1911 Wasmuth Portfolio) in Drawings and Plans of Frank Lloyd Wright: The Early Period (1893-1909)*. Dover Architecture 1983.

Wright, Frank Lloyd. *The Japanese Print, an Interpretation*. The Ralph Fletcher Seymour co., Chicago, 1912.

Wright, Frank Lloyd. In the Cause of Architecture; *Second Paper*. *Architectural Record*, May 1914.

Wright, Frank Lloyd. *The Natural House*. New York, Penguin Books, 1954.

Wright, Frank Lloyd. *Testament*. New York, Bramhall House, 1957.

Zerbey, Nancy. New England Architecture | Guide to House Styles in New England. *New England Today Living*, May 9, 2018. <https://newengland.com/today/living/homes/new-england-architecture/>



First, a quick review of his “*Formative Years*”

- PART 1 Ages 0 to19
- PART 2 Ages 20 to 33



RECALL FRANK LLOYD WRIGHT'S EARLIEST INFLUENCES (UNTIL AGE 19)

[FROEBEL 2013, PENN RARE BOOK 2014, HUXTABLE 2004, STORRER 2017, WRIGHT 1957, BURNS 2001]

- **FROEBEL** influenced by Taoism and Buddhism
 - Japanese Shinto rooted in Chinese Taoism
 - Shinto Gods in everything, especially **nature**
 - FLW would later love Japanese Art, Design, and Culture
- Mother's family were all **UNITARIANS**
 - Inspiration from all religions, love **nature**, God in everything

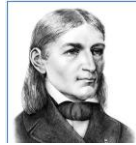

Friedrich Froebel
1782-1852 Germany



Maria **Montessori**
1913 in Italy



MOTHER

Homeschool Teacher
using Froebel System

Others in history homeschooled:
Leonardo da Vinci, Monet, Mozart, Bach,
Newton, Ben Franklin, Edison, Jefferson,
Washington, Einstein, Teddy and
Franklin-Delano Roosevelt, Churchill,
John Muir, and the Wright brothers



FATHER

Preacher, Lawyer, School Superintendent, Teacher, Musician
B.A., M.A. Colgate University

"Artist, photographer, and designer of furniture, graphics, books, and buildings, his patronage of Chinese and Japanese art, his obsession with every aspect of his surroundings, his dedicated collecting of beautiful things, owed much to his father" [Huxtable 2004]



Most of childhood in rural **WISCONSIN**

- Like Pennsylvania farmland



Frank Lloyd Wright 1867-1959



Future
Designers

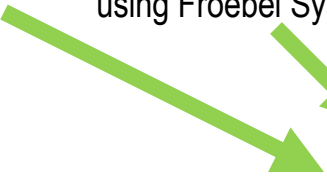

Recall: INFLUENCES up to Age 34 (1901)

PLACES

- New England, mostly Rural Wisconsin
- Chicago, and Oak Park suburb



Wisconsin Farms until age 20



1887 CHICAGO

PEOPLE

- Early life: Father Preacher/Musician, Mother Teacher & Unitarian farmer family
- His 20's and early 30's: Wife and first five of six children

- Architects:



Allan Conover



Joseph Silsbee



Louis Sullivan



Wife Catherine

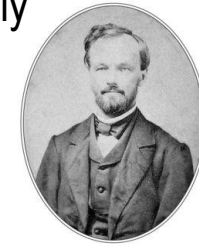

Father
William Carey
Wright



Mother
Anna
Lloyd-Jones

EVENTS

- Industrial Revolution
- Rebuilding Chicago after 1871 fire
- 1893 Chicago Worlds Fair
- Designed home and studio
- Starts own practice
- Designed homes in Oak Park IL



He sees Japanese Pavilion at 1893 Worlds Fair



His home and studio in Oak Park



First project of his own Practice

“THE ART AND CRAFT OF THE MACHINE”

[WRIGHT 1901]

at age 34 (1901)

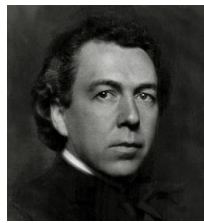

Frank Lloyd Wright

*“... the machine is the metamorphosis of ancient art and craft... **we are at last face to face with the machine - the modern Sphinx - whose riddle the artist must solve** ... I hope to prove that the machine is capable of carrying to fruition high ideals in art ... ”*

*“Machines and the automatic process... **Quantity production** ... was already an inflexible necessity, either as enemy or friend, commercial machine standardization had taken the life of handcraft ... I wanted to realize genuine new forms.”*



ORGANIC ARCHITECTURE

DESIGN PRINCIPLES

Frank
Lloyd
Wright

[WRIGHT 1908 , WRIGHT 1954, WRIGHT 1957, WRIGHT 1908]

CONFORM TO SITE, sun, hillsides, planes close to earth identify with ground



PINWHEELED PLANES (Prairie Style) CRUCIFORM

- around BROAD CENTRAL CHIMNEY, and with LONG OVERHANGS

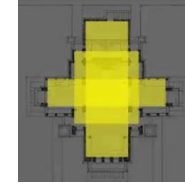

FOLDED PLANE like origami ...continuity...walls, ceilings, and floors become one

HUMAN SCALE is true building scale

FORM and FUNCTION are one! – *not one following other, secondarily*

SIMPLE GEOMETRIES



OPEN FLOOR PLAN



- A unified whole - inside and out - ORCHESTRATE SUN
- DESTROY THE BOX -- eliminate Victorian box-type rooms
- Use materials in NATURAL STATE -- same on exterior and interior
- Walls become screens - FLOW between interior & exterior – BANDS of WINDOWS, FRAME VIEWS
- Interior space made exterior as architecture – like [ENGAWA](#)



COMPRESSION & RELEASE – intentionally cramped entry to magnify architecture as it unfolds

Bring out NATURE of materials - Innovate materials

Color schemes of soft WARM OPTIMISTIC TONES of earth, and autumn leaves

Fixtures assimilated into structure... much of furniture built-in

Architecture = MUSIC ... from an early age !



Inspirations from Japan, and Italy



34 YEARS OLD (1901)

[STORRER 2017]

Gate to River Forest Neighborhood
(next to Oak Park IL)



Frank Lloyd Wright



2019,20 LECTURE: 31 Frank Lloyd Wright sites, plus two FLW influenced family homes

211 views • Jul 10, 2019

👍 2 🗨️ 0 ➦ SHARE ⚙️ SAVE ...

 Joseph Wunderlich
9 subscribers

ANALYTICS

EDIT VIDEO

Wunderlich
Vlog Lecture
on
YouTube Channel



PLANE

“The *FLOOR PLANE* sustains the force of gravity as we move around and place objects” [1]



From Wunderlich
Lecture Series on
ARCHITECTURE
THEORY



“... together with the *OVERHEAD CEILING PLANE*, it can define a spatial zone without walls” [1]



From Wunderlich
Lecture Series on
ARCHITECTURE
THEORY



CRUCIFORM (PINWHEELED PLANES)

A regular COMPOSITION of regular FORMS

The CRUCIFORM, Pin-wheeled Planes of Frank Lloyd Wright

ARCHITECTURE



Frank Lloyd Wright
1867-1958

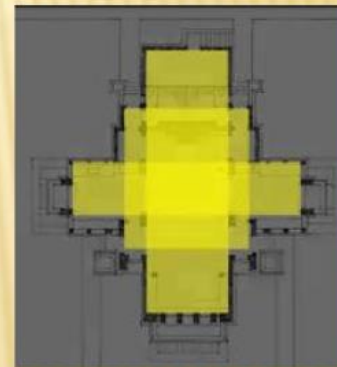
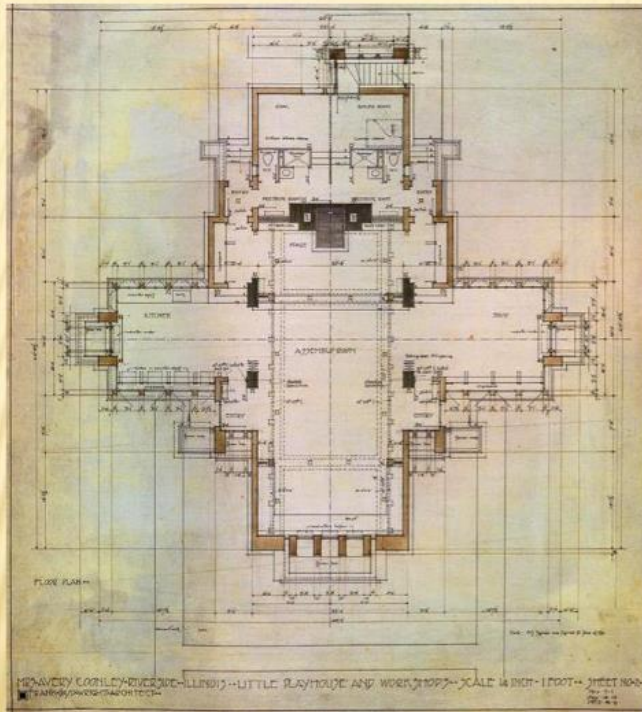

From Wunderlich
Lecture Series on
ARCHITECTURE
THEORY

Coonley Playhouse, Riverside IL. 1912 by Frank Lloyd Wright

<https://www.pinterest.com/pin/412923859572244251/>



PLANE

"A transparent spatial membrane stretched between two parallel lines" [1]

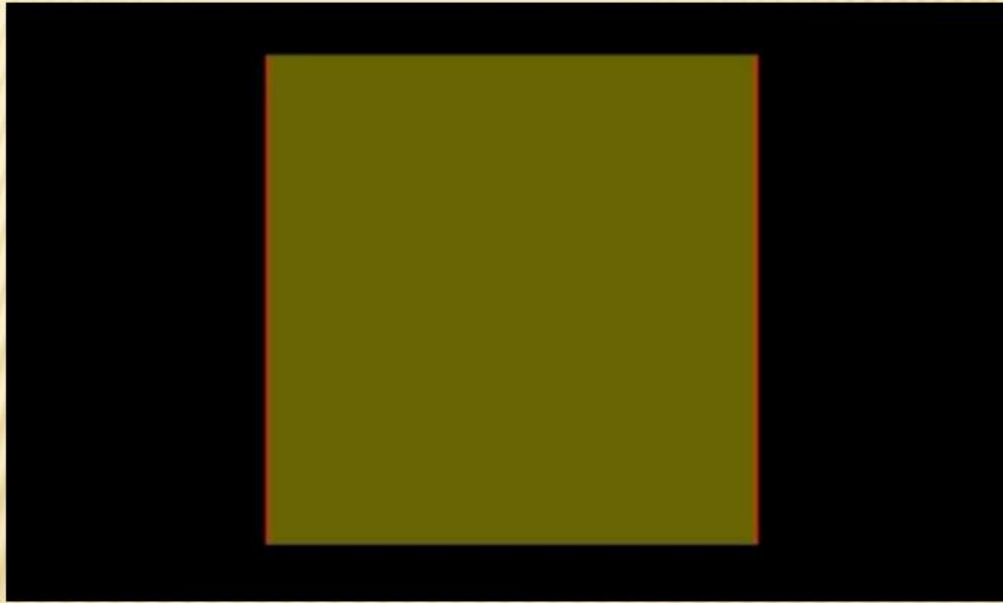

From Wunderlich
Lecture Series on
ARCHITECTURE
THEORY



perception of the PLANE

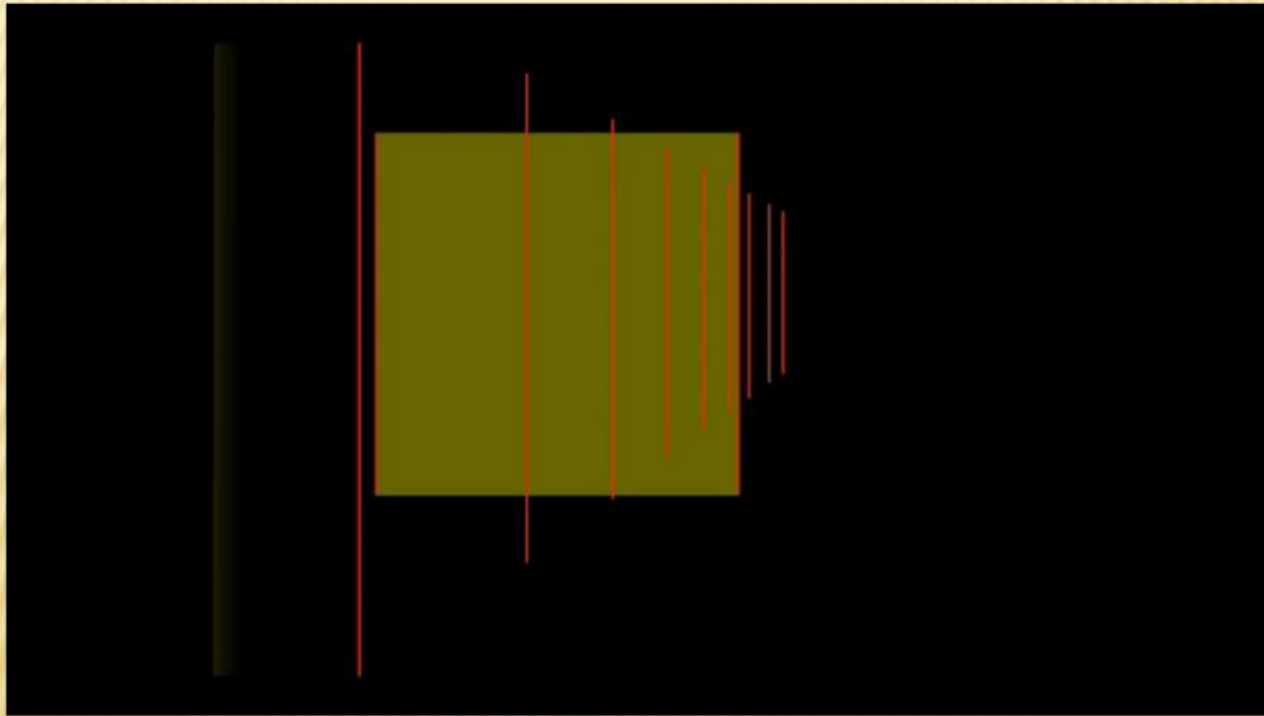

From Wunderlich
Lecture Series on
ARCHITECTURE
THEORY



perception of the PLANE

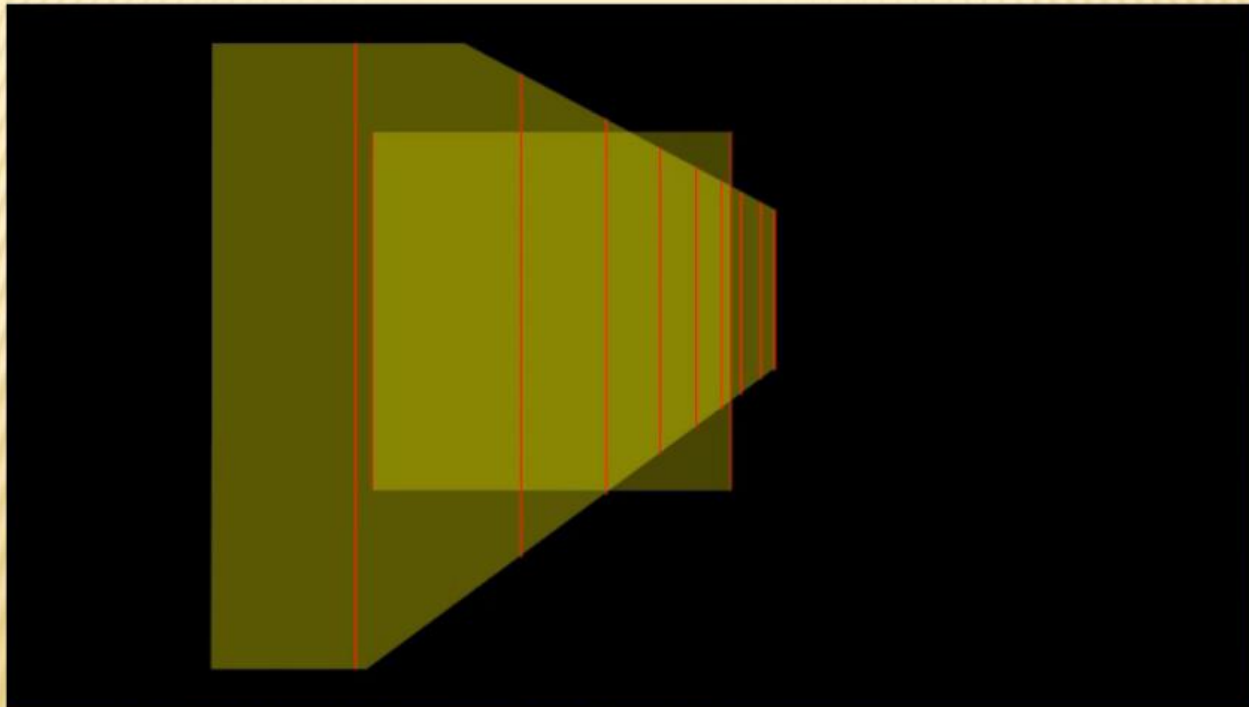

From Wunderlich
Lecture Series on
ARCHITECTURE
THEORY



perception of the PLANE

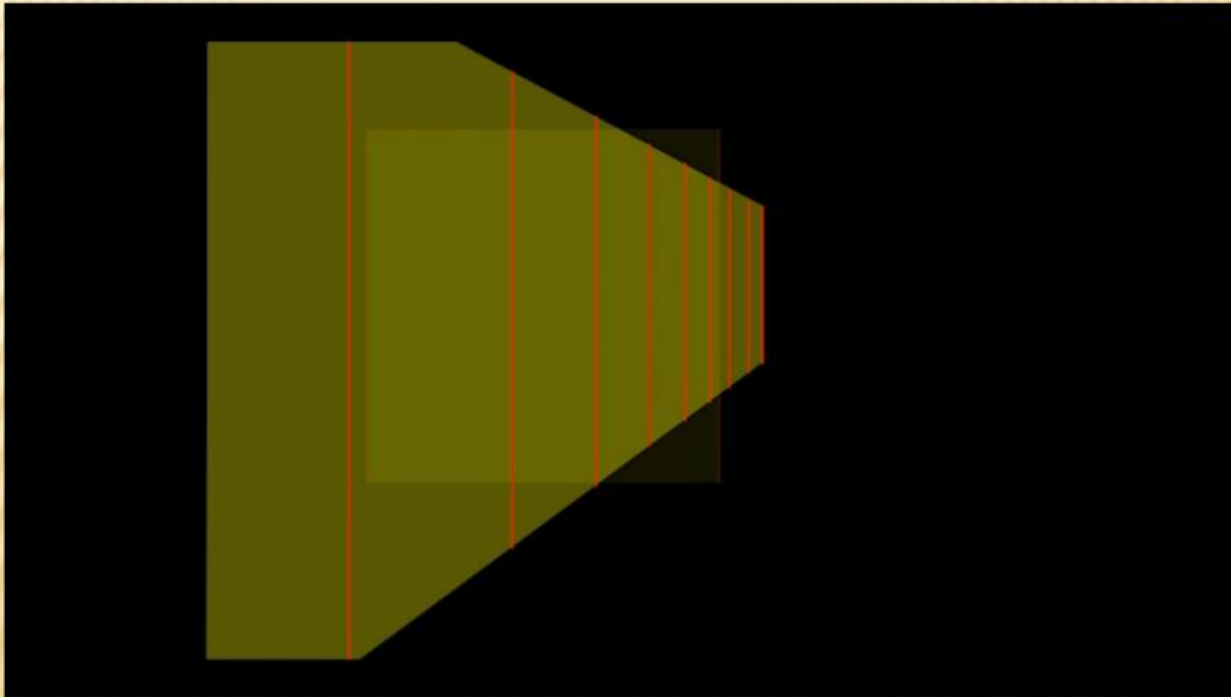

From Wunderlich
Lecture Series on
ARCHITECTURE
THEORY



LINES-> Perceived PLANE, COLONNADE

“Lines can form a series of columns establishing a *COLONNADE* ...
the penetrable boundary (plane) of *adjacent spaces*”[1]



From Wunderlich
Lecture Series on
ARCHITECTURE
THEORY



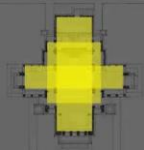

CRUCIFORM + PERCEIVED VERTICAL PLANES facilitate OPEN PLANS, and INDOOR/OUTDOOR SPACE's



Frank Lloyd Wright

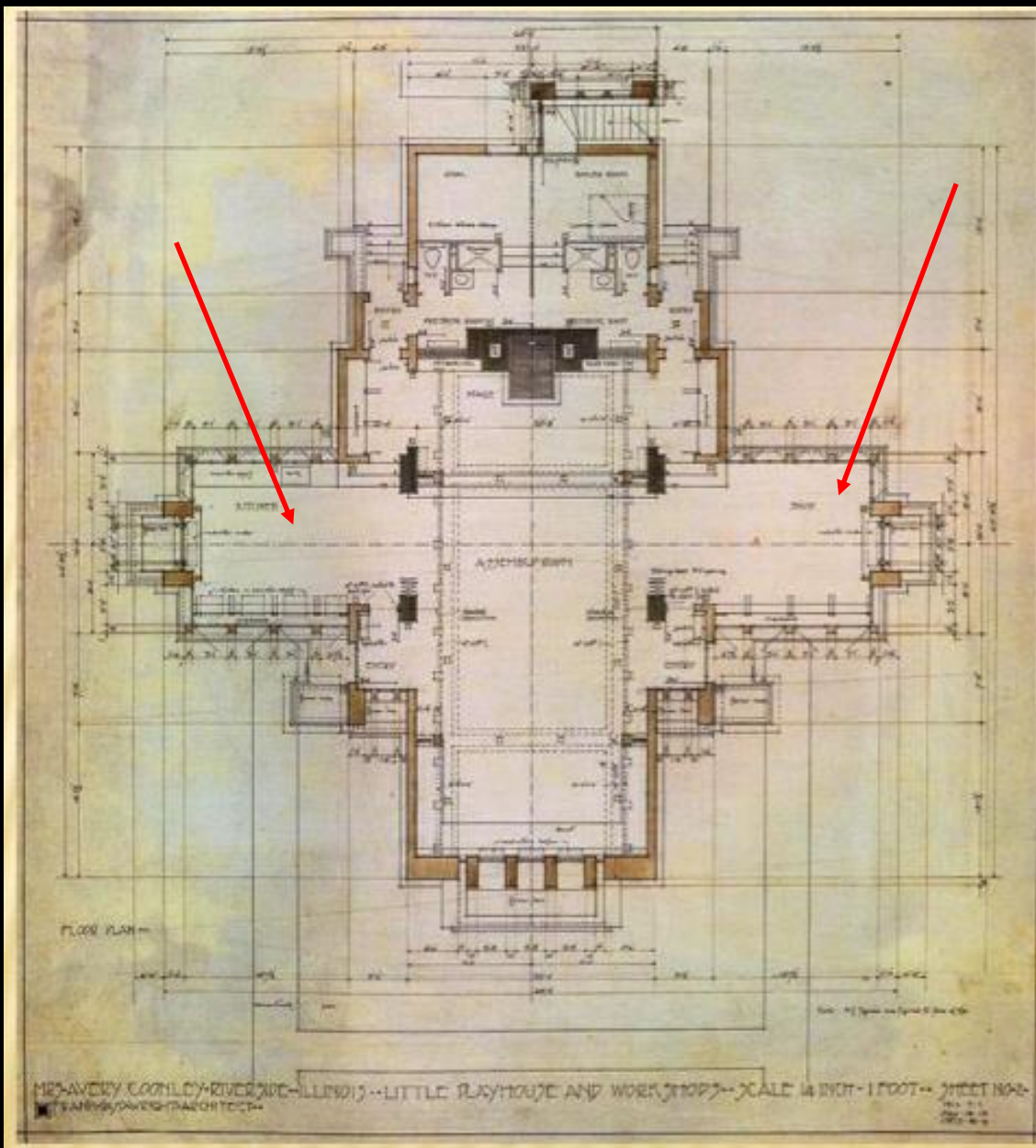

From Wunderlich
Lecture Series on
ARCHITECTURE
THEORY



INDOOR / OUTDOOR SPACE's and PERCEIVED VERTICAL PLANES

Japanese **ENGAWA**

stop, or come back, to watch this: <https://www.youtube.com/watch?v=R1EFyca7MHQ>
(i.e., we only referenced it in last lecture, regarding **BANDING WINDOWS**)

OPENINGS

"As wall openings increase in size, views become part of the spatial experience" [1]



The Japanese **ENGAWA** (a veranda, an enclosed porch).

VIDEO: <https://www.youtube.com/watch?v=R1EFyca7MHQ>

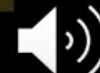

From Wunderlich
Lecture on
“**INTERIORS**”
in Materials &
Methods course
on
[YouTube Channel](#)



The OPEN FLOOR PLAN by FLW, is common in Japan (with movable screens for separating spaces), as seen by FLW in 1893 Chicago worlds fair, as well as on his 1906 Japan trip.

PERCEIVED SEPERATIONS via window/door bands, colonnades, furnishings, lighting, changes in ceiling heights, and strategically aligning lines of site between spaces.

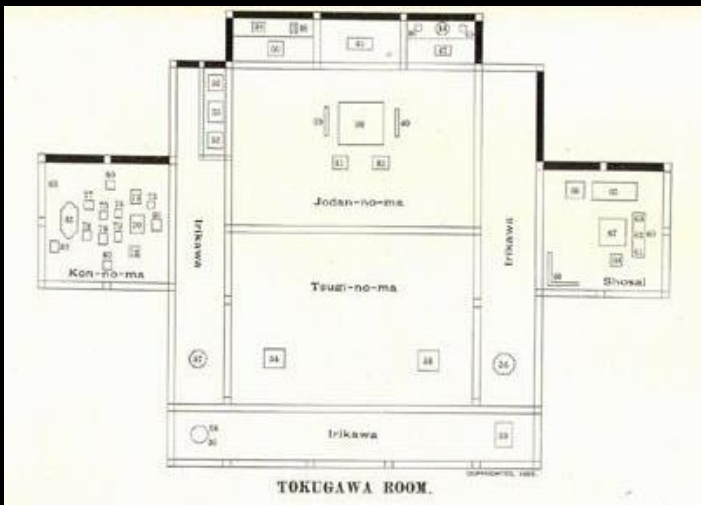

Frank Lloyd Wright



From Wunderlich
Lecture Series on
ARCHITECTURE
THEORY

And
Lecture on
“INTERIORS”
in Materials & Methods
course
on
YouTube Channel



34 YEARS OLD (1901)

[WRIGHT 1908 , WRIGHT 1954, WRIGHT 1957, WRIGHT 1908, STORRER 2017]



Frank Lloyd Wright

His “**PRAIRIE STYLE**” emphasizes the **HORIZONTAL**

“I extended horizontal spacing without enlarging the building by cutting out all the room partitions that did not serve the kitchen or give needed privacy... Freedom of floor space and elimination of useless Heights ...Sense of repose in flat planes and quiet streamline effects”

His **PRAIRIE STYLE** expands on his **ORGANIC ARCHITECTURE**

- *“Planes close to earth identify with ground”*
 - Complimenting wide open plains of the Midwest

His” **HORIZONTAL**” also emphasized by:

- Low ceilings and **bands of windows**
- Wall above window bands painted same color as ceiling
- **Bands of** interior horizontal **trim** work
- **Extended** roof **overhangs**, and long **cantilevered** balconies
- Exterior facades of **horizontal Board and Batten** or **Roman Brick** (*thin*)
- **Folded Plane** -- like origami ... *“Continuity”*...
 - *”walls, ceilings, and floors become one”*
- **Pin-wheeled Planes**



34 YEARS OLD (1901)



Frank Lloyd Wright

- PINWHEELED PLANES
- The CRUCIFORM

ARCHITECTURE

"Pin-wheeled Planes CRUCIFORM" [3]

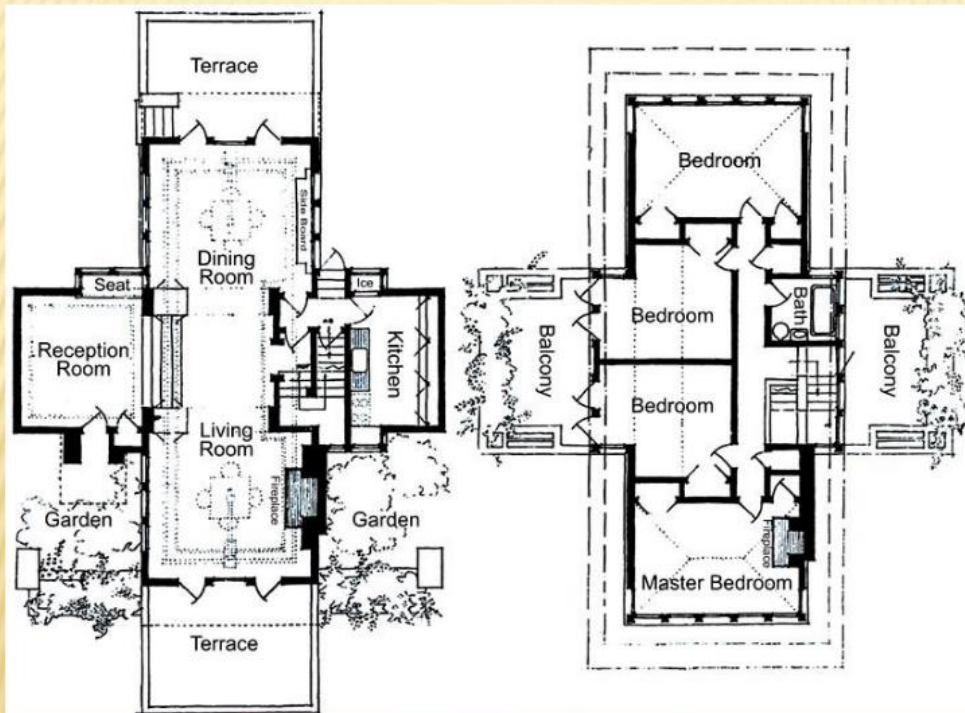

Frank Lloyd Wright
1867-1958

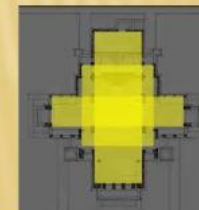

Prairie-style CRUCIFORM pinwheeled-plane type floor plan
<http://www.steinerag.com/flw/Artifact%20Pages/PhRtS142.htm>

From Wunderlich
Lecture Series on
ARCHITECTURE
THEORY



34 YEARS OLD (1901)

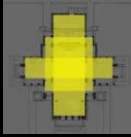

CRUCIFORM + PERCEIVED VERTICAL PLANES



Frank Lloyd Wright

PRAIRIE STYLE

Willetts House
Highland Park, IL



34 YEARS OLD (1901)

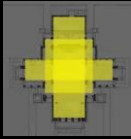

CRUCIFORM + PERCEIVED VERTICAL PLANES



Frank Lloyd Wright

PRAIRIE STYLE



Frank W Thomas
House
Oak Park, IL



Wunderlich
Vlog Lecture
on
YouTube Channel

2019,20 LECTURE: 31 Frank Lloyd Wright sites, plus two FLW influenced family homes

211 views · Jul 10, 2019

👍 2 🗨️ 0 ➦ SHARE 📌 SAVE ...



Joseph Wunderlich
9 subscribers

SUBSCRIBE



34 YEARS OLD (1901)

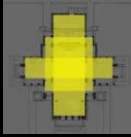

CRUCIFORM + PERCEIVED VERTICAL PLANES



Frank Lloyd Wright

PRAIRIE STYLE



B. Harley Bradley
House
Kankakee, IL



34 YEARS OLD (1901)

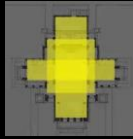

CRUCIFORM + PERCEIVED VERTICAL PLANES



Frank Lloyd Wright

These three 1901 designs are each considered his first *mature PRAIRIE- SCHOOL STYLE* by *different scholars*

Willetts House
Highland Park, IL



Frank W Thomas House
Oak Park, IL

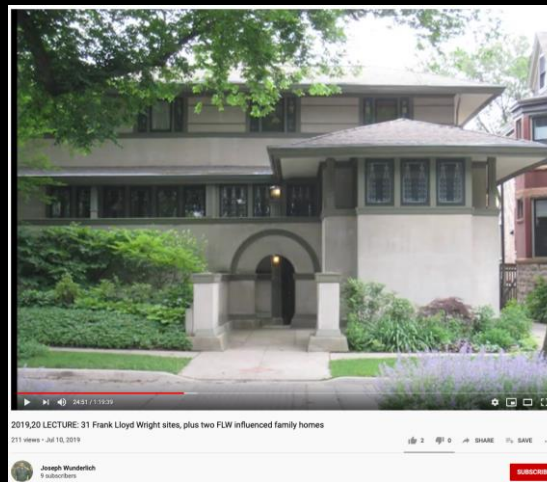

B. Harley Bradley House
Kankakee, IL



Even though FLW said that the Thomas house was the first of his prairie houses, he also said his earlier 1894 Winslow residence was a prairie style. The Thomas house is more of the mature established Prairie school style with all the accompanying features



Wunderlich
[Vlog Lecture](#)
on
[YouTube Channel](#)



34 YEARS OLD (1901)

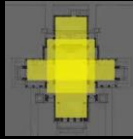

CRUCIFORM + PERCEIVED VERTICAL PLANES



Frank Lloyd Wright

Prairie-school, three stories



2019,20 LECTURE: 31 Frank Lloyd Wright sites, plus two FLW influenced family homes

211 views · Jul 10, 2019

👍 2 👎 0 ➔ SHARE ≡ SAVE ...

 Joseph Wunderlich
9 subscribers

SUBSCRIBE

William Frick
House
Oak Park, IL

Wunderlich
Vlog Lecture
on
YouTube Channel



41 YEARS OLD (1908)

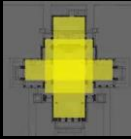

CRUCIFORM + PERCEIVED VERTICAL PLANES



Frank Lloyd Wright



Isabella Roberts
Residence
River Forest, IL

Wunderlich
Vlog Lecture
on
YouTube Channel

2019,20 LECTURE: 31 Frank Lloyd Wright sites, plus two FLW influenced family homes

211 views · Jul 10, 2019

👍 2 🗨️ 0 ➦ SHARE ⚙️ SAVE ...



Joseph Wunderlich
9 subscribers

SUBSCRIBE



42 YEARS OLD (1909)



Frank Lloyd Wright

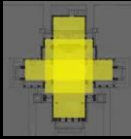

CRUCIFORM + PERCEIVED VERTICAL PLANES

PRAIRIE STYLE



Robie House
Chicago, IL

Wunderlich
Vlog Lecture
on
YouTube Channel

2019,20 LECTURE: 31 Frank Lloyd Wright sites, plus two FLW influenced family homes

211 views • Jul 10, 2019

👍 2 🗨️ 0 ➔ SHARE ≡ SAVE ...



Joseph Wunderlich
9 subscribers

SUBSCRIBE



42 YEARS OLD (1909)

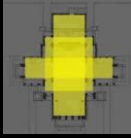

CRUCIFORM + PERCEIVED VERTICAL PLANES



Frank Lloyd Wright



Robie House
Chicago, IL



Wunderlich
Vlog Lecture
on
YouTube Channel



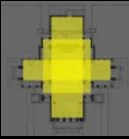

CRUCIFORM + PERCEIVED VERTICAL PLANES



Early 1900s
Wunderlich family
(wife's family – “Carl
Carlson”) home likely
inspired by Frank
Lloyd Wright designs

Batavia IL

Wunderlich
Vlog Lecture
on
YouTube Channel

2019,20 LECTURE: 31 Frank Lloyd Wright sites, plus two FLW influenced family homes

211 views • Jul 10, 2019

👍 2 🗨️ 0 ➦ SHARE ≡ SAVE ...



Joseph Wunderlich
9 subscribers

SUBSCRIBE



35 YEARS OLD (1902)

[STORRER 2017]

HORIZONTAL Board and Batten

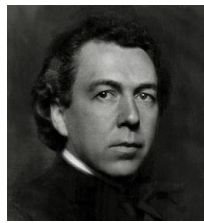

Frank Lloyd Wright



S. 063 John A. Mosher Residence, Ohio 1902



35 YEARS OLD (1902)

Brick laid to look like HORIZONTAL Board and Batten



Frank Lloyd Wright



Arthur and Grace
Heurtley Residence
Oak Park, IL

Wunderlich
Vlog Lecture
on
YouTube Channel

2019,20 LECTURE: 31 Frank Lloyd Wright sites, plus two FLW influenced family homes

203 views · Jul 10, 2019

👍 2 🗨️ 0 ➦ SHARE ⌵ SAVE ...



Joseph Wunderlich
9 subscribers

SUBSCRIBE



36 YEARS OLD (1903)

[STORRER 2017]

Roman Brick (*thin*) – accentuates the **HORIZONTAL**



Frank Lloyd Wright



Darwin D. **Martin House**, Buffalo, NY



Roman brick used on a Wunderlich family residence (wife's father's home - "John Drozd") – for façade and chimney. Lemont IL, a suburb of Chicago in the 1950's.

See more in Wunderlich [Vlog Lecture](#) on [YouTube Channel](#)

2019,20 LECTURE: 31 Frank Lloyd Wright sites, plus two FLW influenced family homes

211 Views · Jul 10, 2019

2 0 SHARE SAVE ...

Joseph Wunderlich
9 subscribers

ANALYTICS EDIT VIDEO



35 YEARS OLD (1902)

[STORRER 2017]

Continued **Simple Geometric Shapes**

- from childhood playing with **wood blocks**

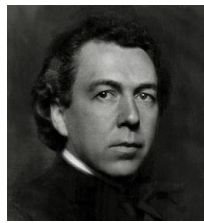

Frank Lloyd Wright



Francis W. and Mary **Little Residence**, IL



36 YEARS OLD (1903)

[STORRER 2017]

Continued **Simple Geometric Shapes**

- from childhood playing with **wood blocks**

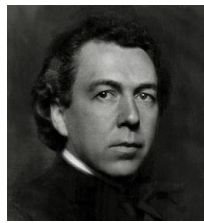

Frank Lloyd Wright



Darwin D. Martin Estate, NY



36 YEARS OLD (1903)

[STORRER 2017]

- A School for his Aunts Jane and Ellan to teach
- On Grounds of Taliesin

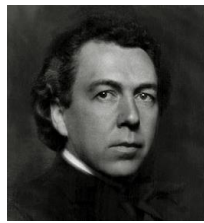

Frank Lloyd Wright



Hillside Homeschool II, Spring Green WI



37 YEARS OLD (1904)

[STORRER 2017]

Continued **Simple Geometric Shapes**

- from childhood playing with **wood blocks**

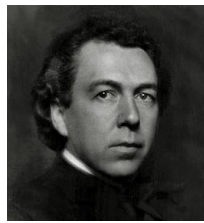

Frank Lloyd Wright



Larkin Administration Building, Buffalo NY, 1903, torn down in 1950



37 YEARS OLD (1904)

[STORRER 2017]



Frank Lloyd Wright

- First commission for a large commercial building (non-residential)
- Unfortunately torn down in 1950
- Revolutionary ideas in office spaces
- Watch simulation! <https://www.youtube.com/watch?v=GvCIXNrYVVg>



Frank Lloyd Wright: The Lost Works - Larkin Administration Building

47,237 views • Mar 7, 2018

692 10 SHARE SAVE ...



Frank Lloyd Wright Trust
3.07K subscribers

SUBSCRIBE



Larkin Administration Building, Buffalo NY, 1903, torn down in 1950

37 YEARS OLD (1904)

[STORRER 2017]



Frank Lloyd Wright

- Watch simulation! <https://www.youtube.com/watch?v=GvCIXNrYVVg>



Frank Lloyd Wright: The Lost Works - Larkin Administration Building

47,237 views · Mar 7, 2018

692 likes 10 comments SHARE SAVE ...



Frank Lloyd Wright Trust
3.07k subscribers

SUBSCRIBE



Larkin Administration Building, Buffalo NY, 1903, **torn down in 1950**

RECALL JAPANESE INFLUENCE FROM LECTURE ON AGES 20 TO 33

[HO-O-DEN 2018, STORRER 2017]



Frank Lloyd Wright

What he saw at the Chicago Worlds Fair during those early years:

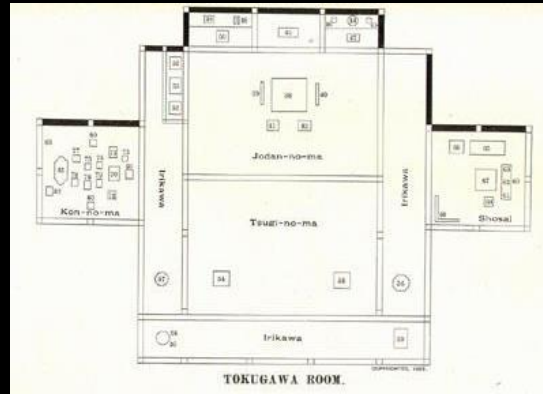

OPEN FLOOR PLAN



And his works during those early years showing Japanese influences:

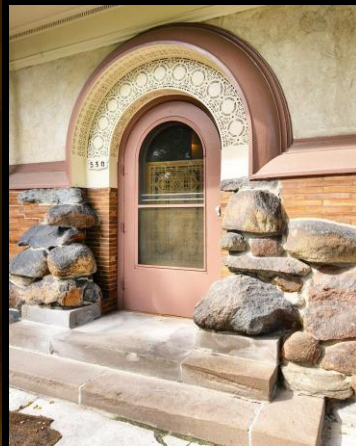

38 YEARS OLD (1905)

[FRANK LLOYD WRIGHT TRUST 2017]



Frank Lloyd Wright

He Continued being influenced by Japan
with **first trip to Japan** in 1905



2013 Photo by J Wunderlich in Kyoto



1905 Photo
by Frank Lloyd Wright
in Nagoya





38 YEARS OLD (1905)

[FRANK LLOYD WRIGHT TRUST 2017]

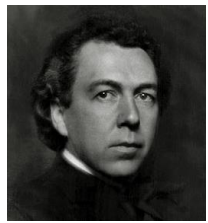

Frank Lloyd Wright

1905 Photo by Frank Lloyd Wright of
Ikuta Shrine in Nagoya



2013 Photo by J Wunderlich in Kyoto



1900: Road to Ikuta Shrine by unknown photographer



38 YEARS OLD (1905)

[FRANK LLOYD WRIGHT TRUST 2017]



Frank Lloyd Wright



2013 Photo by J Wunderlich in Kyoto



1905 Photo
by Frank Lloyd Wright
Location unknown



38 YEARS OLD (1905)

[FRANK LLOYD WRIGHT TRUST 2017]



Frank Lloyd Wright



2013 Photo by J Wunderlich in Kyoto



1905 Photo
by Frank Lloyd Wright
in Kyoto



38 YEARS OLD (1905)

[FRANK LLOYD WRIGHT TRUST 2017]



Frank Lloyd Wright



1905 Photo
by Frank Lloyd Wright
in Nagoya

38 YEARS OLD (1905)

[FRANK LLOYD WRIGHT TRUST 2017]



Frank Lloyd Wright



2013 Photo by J Wunderlich in Kyoto



1905 Photo
by Frank Lloyd Wright
In Nagoya



38 YEARS OLD (1905)

[FRANK LLOYD WRIGHT TRUST 2017]



Frank Lloyd Wright



2013 Photo by J Wunderlich in Kyoto

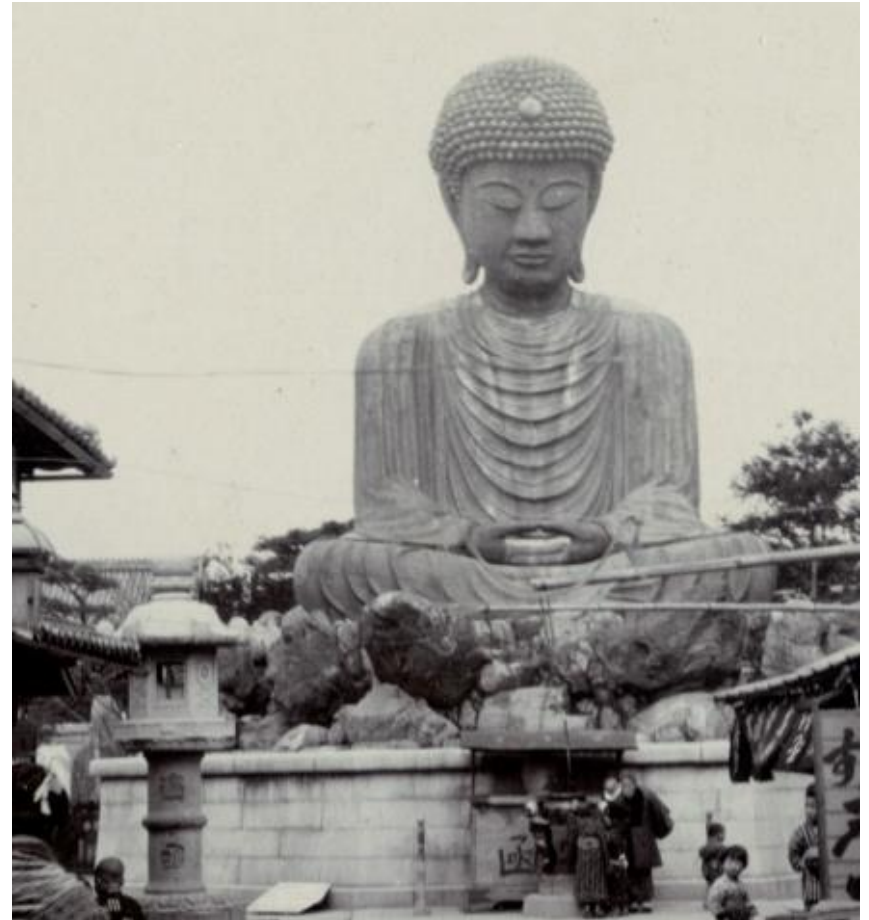

1905 Photo
by Frank Lloyd Wright in
Kobe



38 YEARS OLD (1905)

[FRANK LLOYD WRIGHT TRUST 2017]



Frank Lloyd Wright

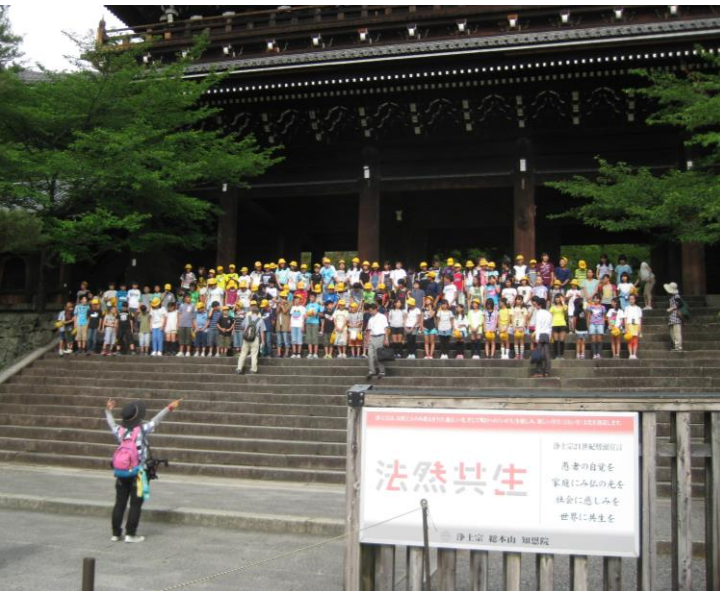

2013 Photo by J Wunderlich in Kyoto



1905 Photo
by Frank Lloyd Wright
in Nagoya



38 YEARS OLD (1905)

[FRANK LLOYD WRIGHT TRUST 2017]



Frank Lloyd Wright



2013 Photo by J Wunderlich in Kyoto



1905 Photo by Frank Lloyd Wright in Nagoya



38 YEARS OLD (1905)

[FRANK LLOYD WRIGHT TRUST 2017]



Frank Lloyd Wright



2013 Photo by J Wunderlich in Kyoto



1905 Photo
by Frank Lloyd Wright
in Nagoya



38 YEARS OLD (1905)

[FRANK LLOYD WRIGHT TRUST 2017]



Frank Lloyd Wright



2013 Photo by J Wunderlich in Kyoto



1905 Photo
by Frank Lloyd Wright
in Nagoya



38 YEARS OLD (1905)

[FRANK LLOYD WRIGHT TRUST 2017]



Frank Lloyd Wright



2013 Photo by J Wunderlich in Kyoto



1905 Photo
by Frank Lloyd Wright
in Nagoya



38 YEARS OLD (1905)

[FRANK LLOYD WRIGHT TRUST 2017]



Frank Lloyd Wright



2013 Photo by J Wunderlich in Kyoto



1905 Photo

by Frank Lloyd Wright

Location unknown



38 YEARS OLD (1905)

[FRANK LLOYD WRIGHT TRUST 2017]



Frank Lloyd Wright



2013 Photo by J Wunderlich in Kyoto



1905 Photo
by Frank Lloyd Wright
in Nagoya



38 YEARS OLD (1905)

[FRANK LLOYD WRIGHT TRUST 2017]



Frank Lloyd Wright



2013 Photo by J Wunderlich in Narita



1905 Photo
by Frank Lloyd Wright
in Kyoto



38 YEARS OLD (1905)

[FRANK LLOYD WRIGHT TRUST 2017]



Frank Lloyd Wright



1905 Photo
by Frank Lloyd Wright
in Nagoya



2013 Photo by J Wunderlich in Narita



2013 Photo by J Wunderlich in Narita





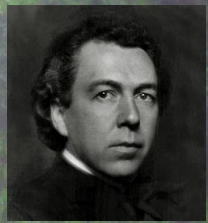

Frank Lloyd Wright

“the west could not have easily seen an indigenous organic architecture... civilizations based on ... cultural inspiration, chiefly Buddhism... could.” “My work is in that deeper philosophic sense”





<http://users.etown.edu/w/wunderjt/judo.htm>



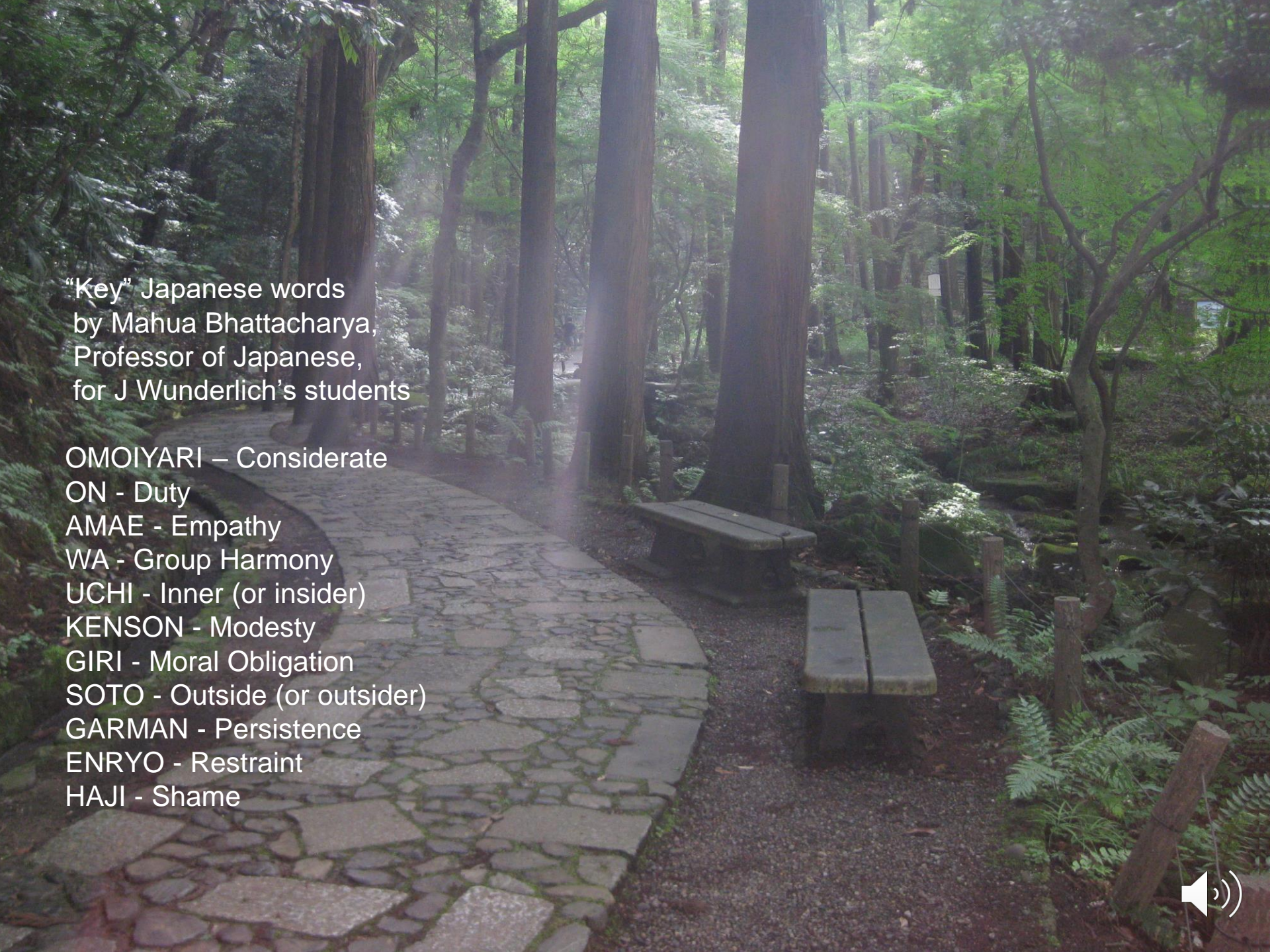

“Key” Japanese words
by Mahua Bhattacharya,
Professor of Japanese,
for J Wunderlich’s students

OMOIYARI – Considerate

ON - Duty

AMAE - Empathy

WA - Group Harmony

UCHI - Inner (or insider)

KENSON - Modesty

GIRI - Moral Obligation

SOTO - Outside (or outsider)

GARMAN - Persistence

ENRYO - Restraint

HAJI - Shame



38 YEARS OLD (1905)

[FRANK LLOYD WRIGHT TRUST 2018]

- Same year as first trip to Japan



Nagoya Japan, 1900

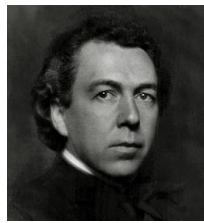

Frank Lloyd Wright



Unity Temple, Oak Park IL



38 YEARS OLD (1905)



Frank Lloyd Wright

SHAPE - SQUARE



Frank Lloyd Wright
1867-1958

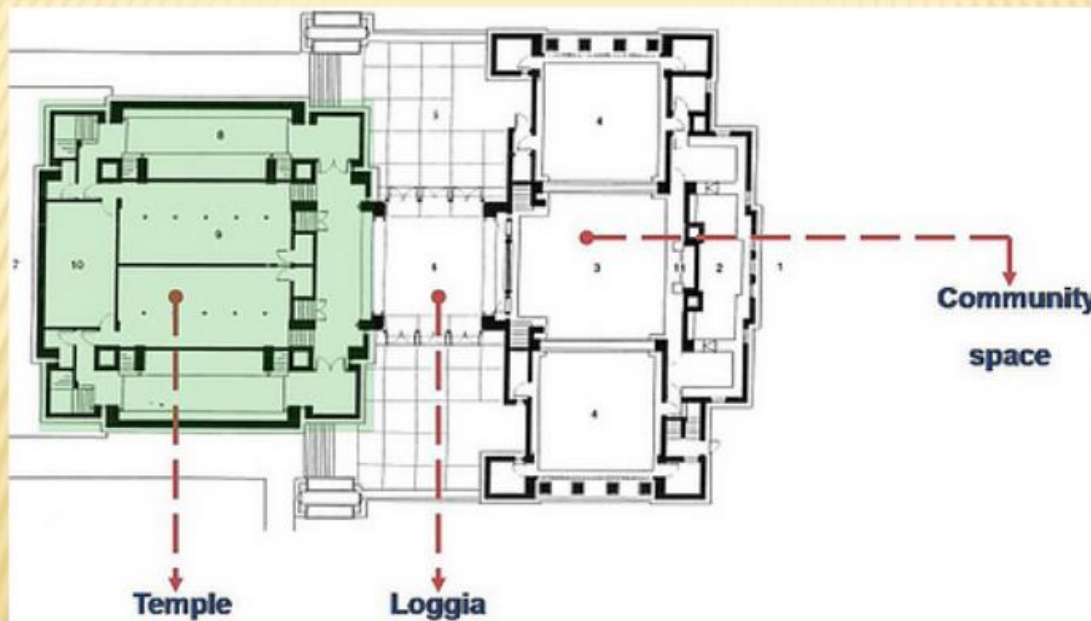

Unity Temple in Oak Park, 1905 Frank Lloyd Wright
(UNITARIAN)

<http://lloydandalex.blogspot.com/2014/10/usa-31-frank-lloyd-wright-unity-temple.html>

From Wunderlich
Lecture Series on
ARCHITECTURE
THEORY

Unity Temple, Oak Park IL



38 YEARS OLD (1905)

Temple Floor raised

Like Japanese Buddhist temple visited in 2013

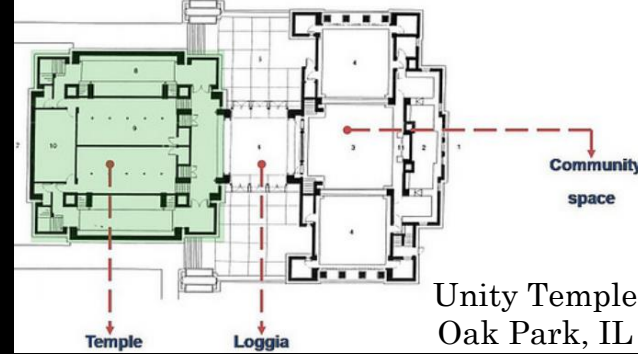

Frank Lloyd Wright

Unity Temple
Oak Park, IL



From Wunderlich
Lecture Series on
ARCHITECTURE
THEORY



38 YEARS OLD (1905)

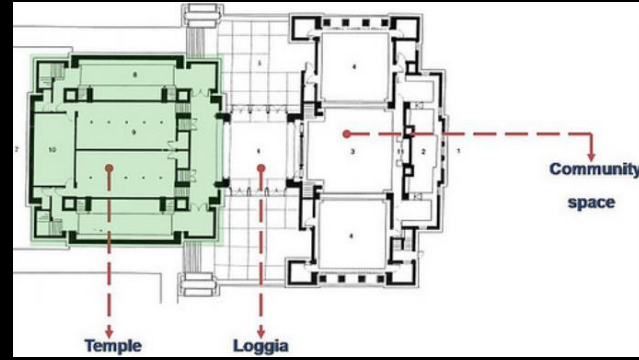

Frank Lloyd Wright

Temple Floor raised

Elevated or sunken planes

"An elevated plane separates from surroundings and creates a domain within a larger spatial context. It's vertical edges help define it

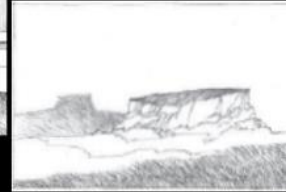
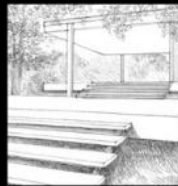
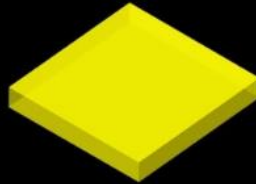

... a sunken plane defines a volume of space isolated from a larger context. . It's vertical edges help define it



...a plane overhead defines a volume of space beneath it" [1]

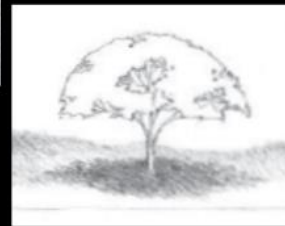
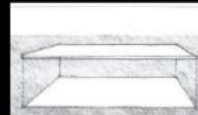

Unity Temple
Oak Park, IL

From Wunderlich
Lecture Series on
ARCHITECTURE
THEORY



38 YEARS OLD (1905)

[FRANK LLOYD WRIGHT TRUST 2018]

- Same year as first trip to Japan



Nagoya Japan, 1900



Frank Lloyd Wright



Unity Temple, Oak Park IL



38 YEARS OLD (1905)

[FRANK LLOYD WRIGHT TRUST 2018]

Wright stated *“Unity Temple is where you will find the first real expression of the idea that the space within the building is the reality of that building”*



Frank Lloyd Wright



Unity Temple, Oak Park IL



38 YEARS OLD (1905)
[FRANK LLOYD WRIGHT TRUST 2018]

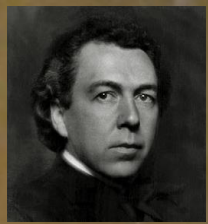

Frank Lloyd Wright



Unity Temple, Oak Park IL

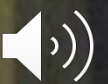



Frank Lloyd Wright
38 YEARS OLD
(1905)

Wunderlich
Vlog Lecture
on
YouTube Channel



Unity Temple, Oak Park IL





Unity Temple, Oak Park IL



39 YEARS OLD (1906)

[STORRER 2017]

- One year after his first trip to Japan



Frank Lloyd Wright



Robie House, Chicago 1906



39 YEARS OLD (1906)

[STORRER 2017]

- One year after his first trip to Japan



Frank Lloyd Wright

Famous Fushimi Inari-aisha shrine
in Kyoto Japan, 711 AD



Recall: S.127 Robie House, Chicago 1906



39 YEARS OLD (1906)

- Designed part of River Forest Tennis Club, next to Oak Park IL
- Wealthy members / Potential clients



Frank Lloyd Wright



39 YEARS OLD (1906)

- Designed part of River Forest Tennis Club, next to Oak Park IL
- Wealthy members / Potential clients



Frank Lloyd Wright



Wunderlich
[Vlog Lecture](#)
on
[YouTube Channel](#)



39 YEARS OLD (1906)

- Designed part of River Forest Tennis Club, next to Oak Park IL
- Wealthy members / Potential clients



Frank Lloyd Wright



Wunderlich
[Vlog Lecture](#)
on
[YouTube Channel](#)



39 YEARS OLD
(1906)



Frank Lloyd Wright

Wunderlich
[Vlog Lecture](#)
on
[YouTube Channel](#)



THE RIVER FOREST TENNIS CLUB

-ESTABLISHED 1905-

The River Forest Tennis Club was established on May 16, 1905, by a group of local residents who wanted to create a club that was both social and athletic in nature. The club was originally located east of this site at the intersection of Lake Street, Quick Avenue, and Bonnie Brae Place on land relinquished by the River Forest Golf Club when it moved west.

The first clubhouse was opened on July 4, 1905, but was destroyed by a fire the following year. A new building was designed by three member-architects, including Frank Lloyd Wright who created the final plans. Completed in 1906 at a cost of \$2,630, the long, narrow structure had a stark simplicity with brown-stained board-and-batten siding.

In 1920, the Cook County Forest Preserve Commission took over the site, and the River Forest Tennis Club moved to its current location. The clubhouse was sawed into three sections, carted via horse-drawn wagons, and rebuilt with an additional 250 square feet. Ten clay tennis courts were added to the grounds and in 1937 an outdoor swimming pool was built. More than 100 years after its completion, this building still plays an integral role in members' enjoyment of the River Forest Tennis Club.



Tim Elvert, Troop 65
Eagle Scout Project, December 2012



40 YEARS OLD (1907)

[STORRER 2017]

- Two years after his first trip to Japan



Frank Lloyd Wright



George Blossom Garage, Chicago 1907



2019,20 LECTURE: 31 Frank Lloyd Wright sites, plus two FLW influenced family homes

218 views • Jul 10, 2019

👍 2 🗨️ 0 SHARE SAVE ...



Joseph Wunderlich
9 subscribers

SUBSCRIBE

Wunderlich
Vlog Lecture
on
YouTube Channel



41 YEARS OLD (1908)



- Also influenced by:
 - **Arts & Crafts movement.** Watch this video:
 - <https://www.youtube.com/watch?v=i1SZqOF3YkM>



Arts & Crafts movement

Frank Lloyd Wright's work is noted on this Arts & Crafts website of the Metropolitan Museum of Art (*the "MET"*) in New York City

https://www.metmuseum.org/toah/hd/acam/hd_acam.htm

THE MET
Heilbrunn Timeline of Art History

The Arts and Crafts Movement in America



The Arts and Crafts movement emerged during the late Victorian period in England, the most industrialized country in the world at that time. Anxieties about industrial life fueled a positive reevaluation of handcraftsmanship and precapitalist forms of culture and society. Arts and Crafts designers sought to improve standards of decorative design, believed to have been debased by mechanization, and to create environments in which beautiful and fine workmanship governed. The Arts and Crafts movement did not promote a particular style, but it did advocate reform as part of its philosophy and instigated a critique of industrial labor; as modern machines replaced workers, Arts and Crafts proponents called for an end to the division of labor and advanced the designer as craftsman.

RELATED

- PRIMARY ESSAYS
 - American Revival Styles, 1840–76
 - Art Nouveau
 - Design Reform
 - Frank Lloyd Wright (1867–1959)
 - Women China Decorators
- + SECONDARY ESSAYS
- + CHRONOLOGY
- + KEYWORDS



Art & Crafts movement

... this MET site also shows a photo of the entire living room of **Frank Lloyd Wright's** Francis W. Little Residence (Minnesota) disassembled and reconstructed in the MET (including windows!) https://www.metmuseum.org/toah/hd/acam/hd_acam.htm



Art & Crafts movement

... this MET site also states the following

“Emerged during late Victorian period in England ... Anxieties about industrial life fueled ... revaluation of handcraftsmanship .

***Frank Lloyd Wright** shaped a new way of living through his completely designed environments, ... which utilized natural materials such as wood, clay, and stone, sparked a revolutionary shift in the American interior ... However, plain surfaces with minimal decorative embellishments were suited to incorporating the machine*

*The brothers Greene (**Green & Green**) fashioned a distinctive style, heavily influenced by Asian design, that reached its zenith with the bungalow, the quintessential Arts and Crafts architectural form, characterized by broad overhanging eaves, articulated woodwork, and an open plan.”*



Art & Crafts movement

Green & Green **Gamble House (1908)** in Pasadena CA is a prime example

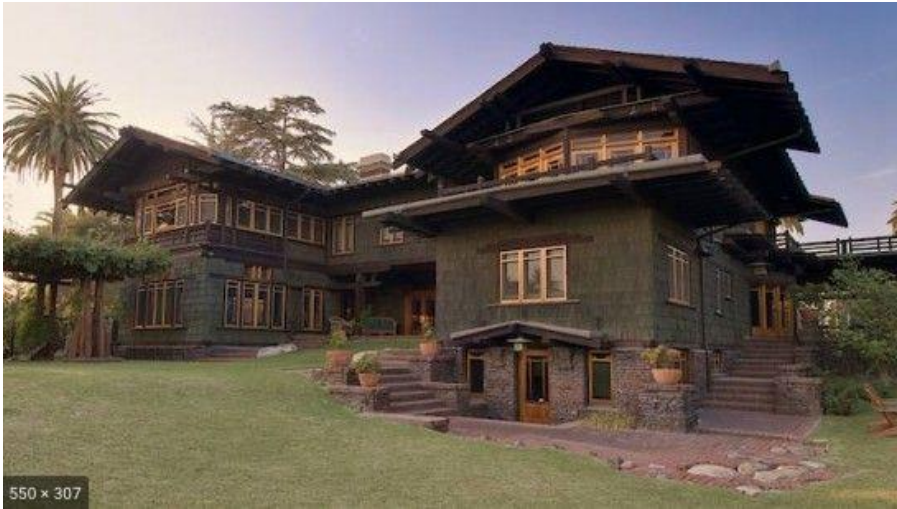

41 YEARS OLD (1908)

- Also influenced by the **Secession Movement** in Vienna, Austria, begun by a group of painters, graphic artists, sculptors, and architects



Frank Lloyd Wright



Edward C. Waller Gates	S.065	River Forest	USA	Illinois	1901		Gate posts and fence restored and reused as entrance to a modern subdivision ^[27]	
Edward C. Waller Poultry House, and Stables	S.066	River Forest	USA	Illinois	1901		Poultry House demolished 1939 Stables demolished early 1970s	
Fred B. Jones House (Penwern)	S.083	Delavan	USA	Wisconsin	1901	1902		
Ward Winfield Willits House	S.054	Highland Park	USA	Illinois	1901			
F. B. Henderson House	S.057	Elmhurst	USA	Illinois	1901	1901		
William G. Fricke House ^[28]	S.058	Oak Park	USA	Illinois	1901			
Buffalo Exposition Pavilion for the Universal Portland Cement Company ^[29]	S.063	Buffalo	USA	New York	1901	1901	Temporary structure Demolished	
Frank W. Thomas House	S.067	Oak Park	USA	Illinois	1901	1901		
E. Arthur Davenport House ^[30]	S.068	River Forest	USA	Illinois	1901			



Frank Lloyd Wright
34 TO 41 YEARS OLD
(1901 TO 1908)

SOURCE:
[HTTPS://EN.WIKIPEDIA.ORG/WIKI/LIST_OF_FRANK_LLOYD_WRIGHT_WORKS](https://en.wikipedia.org/wiki/List_of_Frank_Lloyd_Wright_works)



William E. Martin House ^[31]	S.061	Oak Park	USA	Illinois	1902			
Lake Delavan Yacht Club ^[32]	S.064	Delavan	USA	Wisconsin	1902		Demolished	
Hillside Home School II	S.069	Spring Green	USA	Wisconsin	1901-03	1932, 1952		
Francis W. Little House ^[33]	S.070	Peoria	USA	Illinois	1902	1902	Stable added 1909	
Arthur B. Heurtley House	S.074	Oak Park	USA	Illinois	1902	1902		
Arthur B. Heurtley Summer Cottage	S.075	Marquette Island	USA	Michigan	1902	1902	Remodel	
Mrs. George Gerts Double House, Bridge Cottage	S.077	Whitehall	USA	Michigan	1902			
Dana-Thomas House	S.072	Springfield	USA	Illinois	1902	1902-04	Available for tours.	
Walter Gerts Bridge Cottage	S.078	Whitehall	USA	Michigan	1902			
Alfred W. Hebert House	S.089	Chicago	USA	Illinois	1902		Remodel Partially destroyed by fire 1959; all Wright elements were removed in reconstruction	



Frank Lloyd Wright
34 TO 41 YEARS OLD
(1901 TO 1908)

SOURCE:
[HTTPS://EN.WIKIPEDIA.ORG/WIKI/LIST_OF_FRANK_LLOYD_WRIGHT_WORKS](https://en.wikipedia.org/wiki/List_of_Frank_Lloyd_Wright_works)



George W. Spencer House	S.081	Delavan	USA	Wisconsin	1902			
Charles S. Ross House	S.082	Delavan	USA	Wisconsin	1902			
John A. Mosher House		Wellington	USA	Ohio	1902	1903-04	Original unbuilt house designed for Mosher in Willmette, Illinois. No drawings exist at Taliesin for this house as built. ^[34] It is also not included in several complete lists of Wright works. ^[35]	
George F. Barton House	S.103	Buffalo	USA	New York	1902	1903-04		
Joseph J. Walser, Jr. House	S.091	Chicago	USA	Illinois	1903			
Horse Show Fountain	S.094	Oak Park	USA	Illinois	1903	1909	Rebuilt 1969	
Abraham Lincoln Center ^[36]	S.095	Chicago	USA	Illinois	1903		Design completed by Dwight Perkins	



Frank Lloyd Wright
34 TO 41 YEARS OLD
(1901 TO 1908)

SOURCE:
[HTTPS://EN.WIKIPEDIA.ORG/WIKI/LIST_OF_FRANK_LLOYD_WRIGHT WORKS](https://en.wikipedia.org/wiki/List_of_Frank_Lloyd_Wright_works)



Robert M. Lamp House	S.097	Madison	USA	Wisconsin	1903	1903		
Darwin D. Martin Carriage House, Conservatory, and Pergola	S.101	Buffalo	USA	New York	1903	1903-05	Demolished 1962 Reconstructed 2004-2007	
Darwin D. Martin House	S.100	Buffalo	USA	New York	1903	1904-05	Restored 2004-17	
Edwin H. Cheney House	S.104	Oak Park	USA	Illinois	1903			
Larkin Administration Building	S.093	Buffalo	USA	New York	1904		Demolished 1950	
Unity Temple	S.096	Oak Park	USA	Illinois	1904	1905-08		
Burton J. Westcott House	S.099	Springfield	USA	Ohio	1904	1908		
William R. Heath House	S.105	Buffalo	USA	New York	1904	1904-05		
Ferdinand F. Tomek House (The Ship House)	S.128	Riverside	USA	Illinois	1904	1904-06		
Harvey P. Sutton House	S.106	McCook	USA	Nebraska	1905	1905		



Frank Lloyd Wright
34 TO 41 YEARS OLD
(1901 TO 1908)

SOURCE:
[HTTPS://EN.WIKIPEDIA.ORG/WIKI/LIST_OF
FRANK LLOYD WRIGHT WORKS](https://en.wikipedia.org/wiki/List_of_Frank_Lloyd_Wright_works)





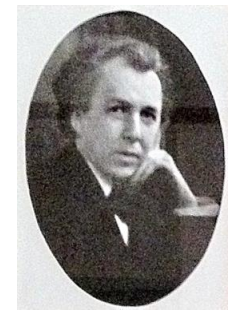





Hiram Baldwin House	S.107	Kenilworth	USA	Illinois	1905	1905		
Mary W. Adams House	S.108	Highland Park	USA	Illinois	1905	1905		
William A. Glasner House	S.109	Glencoe	USA	Illinois	1905	1905		
Charles A. Brown House ^[37]	S.110	Evanston	USA	Illinois	1905			
Frank L. Smith Bank	S.111	Dwight	USA	Illinois	1905	1905		
E. W. Cummings Real Estate Office	S.112	River Forest	USA	Illinois	1905		Demolished 1925	
E-Z Polish Factory	S.114	Chicago	USA	Illinois	1905	1905		
Lawrence Memorial Library (Springfield, Illinois)	S.073	Springfield	USA	Illinois	1905			
A. P. Johnson House	S.087	Delavan	USA	Wisconsin	1905	1905		
Thomas P. Hardy House	S.115	Racine	USA	Wisconsin	1905	1905		



Frank Lloyd Wright
34 TO 41 YEARS OLD
(1901 TO 1908)

SOURCE:
[HTTPS://EN.WIKIPEDIA.ORG/WIKI/LIST_OF_FRANK_LLOYD_WRIGHT_WORKS](https://en.wikipedia.org/wiki/List_of_Frank_Lloyd_Wright_works)



Darwin D. Martin Gardener's Cottage	S.090	Buffalo	USA	New York	1905	1909		
Mrs Thomas H. Gale Cottage I, II & III	S.088.0, S.088.1, S.088.2	Whitehall	USA	Michigan	1905	1909		
Rookery Building lobby	S.113	Chicago	USA	Illinois	1905	1907	Lobby remodeling	
William H. Pettit Mortuary Chapel	S.116	Belvidere	USA	Illinois	1906	1907		
Peter A. Beachy House	S.117	Oak Park	USA	Illinois	1906	1906	Remodel	
Frederick D. Nichols House ^[38]	S.118	Flossmoor	USA	Illinois	1906			
River Forest Tennis Club ^[39]	S.119	River Forest	USA	Illinois	1906		Moved ^[40] 1920 to present location.	
Edward R. Hills House	S.051	Oak Park	USA	Illinois	1906	1906	Remodel Reconstructed after fire 1977	
P. D. Hoyt House	S.120	Geneva	USA	Illinois	1906			
Mrs. A. W. Gridley House (Ravine House)	S.121	Batavia	USA	Illinois	1906	1906		

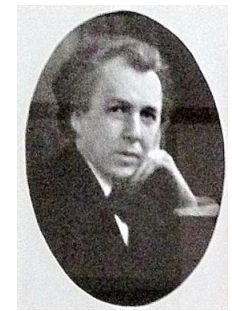

Frank Lloyd Wright
34 TO 41 YEARS OLD
(1901 TO 1908)

SOURCE:
[HTTPS://EN.WIKIPEDIA.ORG/WIKI/LIST_OF_FRANK_LLOYD_WRIGHT WORKS](https://en.wikipedia.org/wiki/List_of_Frank_Lloyd_Wright_works)



Grace Fuller House	S.123	Glencoe	USA	Illinois	1906		Uncertain if ever built	
K. C. DeRhodes House	S.125	South Bend	USA	Indiana	1906	1906		
George M. Millard House	S.126	Highland Park	USA	Illinois	1906	1906		
Tan-Y-Deri (Andrew T. Porter House) ^[41]	S.134	Spring Green	USA	Wisconsin	1907	1907-08	Based on "A Fireproof House for \$5000"	
Avery Coonley House	S.135	Riverside	USA	Illinois	1907		Complex completed 1912	
Stephen M. B. Hunt House I	S.138	La Grange	USA	Illinois	1907	1907	Based on "A Fireproof House for \$5000"	
Col. George Fabyan Villa	S.129	Geneva	USA	Illinois	1907	1907	Remodel	
Fox River Country Club	S.130	Geneva	USA	Illinois	1907		Remodel Destroyed by fire 1910	
Larkin Company Exhibition Pavilion	S.132	Norfolk	USA	Virginia	1907	1907	Temporary structure Demolished	
George Blossom Garage	S.133	Chicago	USA	Illinois	1907	1907		
Pebbles & Balch Office	S.131	Oak Park	USA	Illinois	1907	1907	Remodel Demolished by 1942	

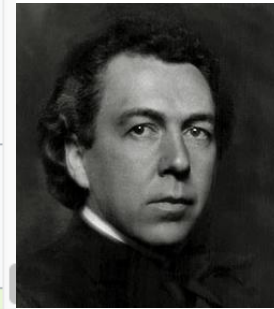

Frank Lloyd Wright
34 TO 41 YEARS OLD
(1901 TO 1908)

SOURCE:
[HTTPS://EN.WIKIPEDIA.ORG/WIKI/LIST_OF_FRANK_LLOYD_WRIGHT_WORKS](https://en.wikipedia.org/wiki/List_of_Frank_Lloyd_Wright_works)



Pebbles & Balch Office	S.131	Oak Park	USA	Illinois	1907	1907	Remodel Demolished by 1942	
Frederick C. Robie House	S.127	Chicago	USA	Illinois	1908	1909-10	Completed restoration in 2019. Available for tours.	
G. C. Stockman House	S.139	Mason City	USA	Iowa	1908	1908	Based on "A Fireproof House for \$5000"	
Raymond W. Evans House	S.140	Chicago	USA	Illinois	1908		Based on "A Fireproof House for \$5000"	
Browne's Bookstore	S.141	Chicago	USA	Illinois	1908		Interior design Demolished 1912 (redesigned for a new tenant)	
L. K. Horner House ^[42]	S.142	Chicago	USA	Illinois	1908		Demolished 1952	
Eugene A. Gilmore House (Airplane House)	S.146	Madison	USA	Wisconsin	1908	1908		
Edward E. Boynton House	S.147	Rochester	USA	New York	1908	1908		
Walter V. Davidson House	S.149	Buffalo	USA	New York	1908	1908		
Isabel Roberts House	S.150, S.394	River Forest	USA	Illinois	1908	1908		

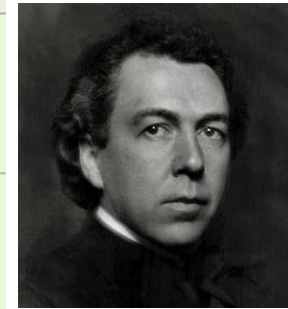

Frank Lloyd Wright
34 TO 41 YEARS OLD
(1901 TO 1908)

SOURCE:
[HTTPS://EN.WIKIPEDIA.ORG/WIKI/LIST_OF_FRANK_LLOYD_WRIGHT_WORKS](https://en.wikipedia.org/wiki/List_of_Frank_Lloyd_Wright_works)





Frank Lloyd Wright
 34 TO 41 YEARS OLD
 (1901 TO 1908)

Meyer May House	S.148	Grand Rapids	USA	Michigan	1908	1908-09	Completely restored, 1986-1987 Open for public tours	
William H. Copeland House	S.158	Oak Park	USA	Illinois	1908	1908-09	Garage 1908 Remodel 1909	
City National Bank Building and Park Inn Hotel	S.155	Mason City	USA	Iowa	1908-09	1909-10	Open for public tours	
Edmund F. Brigham House	S.184	Glencoe	USA	Illinois	1908-09	1915		

SOURCE:
[HTTPS://EN.WIKIPEDIA.ORG/WIKI/LIST_OF_FRANK_LLOYD_WRIGHT_WORKS](https://en.wikipedia.org/wiki/List_of_Frank_Lloyd_Wright_works)



1908
41 YEARS OLD



FRANK LLOYD WRIGHT
ARCHITECT
JUNE 8, 1867 - APRIL 9, 1959



CATHERINE TOBIN WRIGHT
WIFE, MOTHER, ARTIST
MARCH 25, 1871 - MARCH 24, 1959



FRANK LLOYD WRIGHT, JR.
ARCHITECT, LANDSCAPE ARCHITECT
1890 - 1978



PHILIP KENNETH LLOYD WRIGHT
ARCHITECT, TOY DESIGNER
1892 - 1972



CATHERINE WRIGHT
WIFE, MOTHER, ARTIST
1894 - 1979



DAVID SAMUEL WRIGHT
BUILDING PRODUCTS DEALER
1895 - 1997



FRANCES WRIGHT
ARTS & CRAFTS ADMINISTRATOR
1898 - 1959



ROBERT LLEWELLYN WRIGHT
ATTORNEY
1903 - 1986

Ages
34 (1901)
to
41 (1908)
in Chicago



31 Frank Lloyd Wright designs visited, 2019

Watch
Wunderlich
[Vlog Lecture](#)
Time 18:52 to 1:00:45
on
[YouTube Channel](#)

